

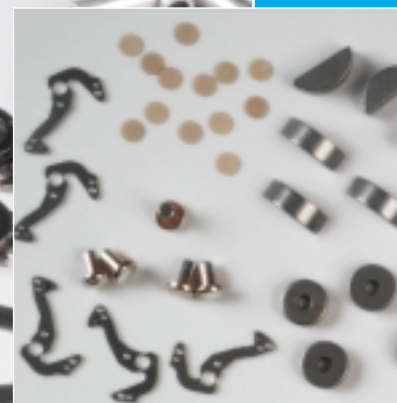

Accurate sorting and gaging of all types of parts

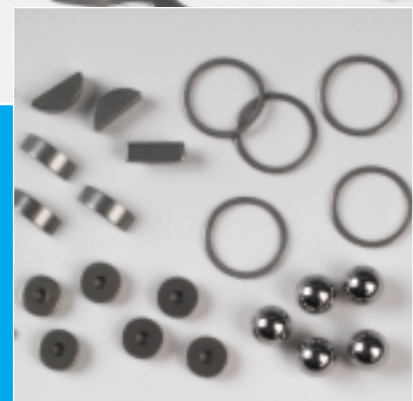

Measurement and sorting of mass-produced parts: the Hugi MS600 is a completely automated industrial system for sorting small parts in any batch size. This guarantees one-hundred percent control of diameters and thicknesses thanks to the graduated clearance of a high-precision pair of roller micrometers. This permits classifications to within thousandths of a millimeter.



Wide Variety of Potential Applications

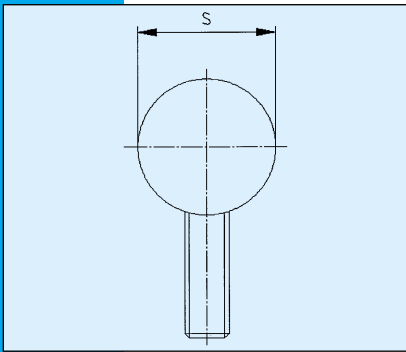

Balls and ball-shaped parts
high-precision joint balls, screws for adjustable feet, and balls of any kind.

No matter what the shape and material of the parts, the Hugi MS600 can be employed wherever reliable measurement and sorting is necessary. This is true both for the smallest number of parts as well as for a capacity of up to 20,000 units per hour. In each case, the sorted size is the largest diameter or the largest thickness. The standard maximum opening between the two rollers is 15 mm, but it can be enhanced to as large as 25 mm. The system can be very quickly adapted to handle different part variants. The machine is designed to permit the roller micrometers to be quickly set and calibrated. The multifunctional feed unit can also be quickly and reliably adapted to new parts by the operator. Another advantage of the machine is that it is also suitable for reliably separating out foreign parts.

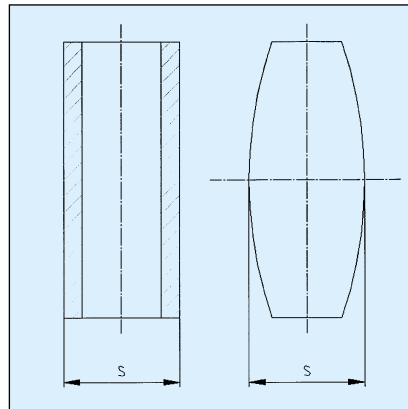

Cylindrical parts
Pins, infusion needles, bearing needles, bushings, cylinder sleeves, etc. with a maximum length of 60 mm.

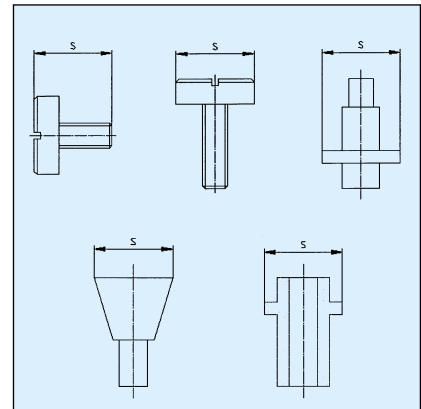

Cylindrically stepped parts
Screws, rivets, stepped shafts, sleeves, inserts, various microelectronic components with a maximum length of 40 to 50 mm.

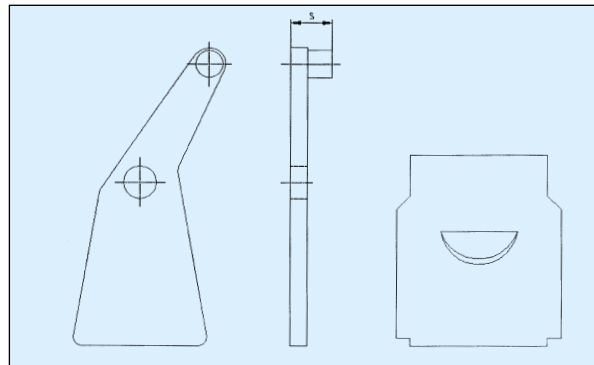

Disk-shaped parts
Washers, rings, tetragonal pins, disks, stampings, gears, etc. with a maximum length of 70 mm.

ryf
Measurement and sorting of mass-produced parts

Technical Data Hugi MS600

Measurement range:	0 to 15 mm, on request expandable to 0 to 25 mm
Maximum length of parts:	* Standard feed, up to 30mm * Special design, up to 60 mm
Precision:	Standard MS600/6 to 6 µm and MS600/2 to 2 µm
Roller drive:	Stepless, electronically controlled three-phase motor
Dimensions:	1,000 x 500 x 400 mm
Weight:	121 kg
Test report:	Every machine is delivered with a test report (calibrated and tested)

Unsurpassed

The accessories can be combined individually, for example a plexi-glass container with hose outlet.



A Proven System

The basic concept was established by HUGL a long time ago, but since then it has been continuously developed and improved. Hence, as an all-rounder, the HUGL MS600 remains unsurpassed. The standard table-top model design is available as the MS600/2 with an accuracy to within 2 μm or as MS600/6 with an accuracy to within 6 μm .

Individual Modules

The hopper unit assure that the bowl feeder is continuously supplied. The presence control unit optoelectronically detects the parts arriving between the micrometer rollers. If they are not detected because the feeder is empty or a disruption has occurred, the device is shut down and an alarm is triggered (blinking light or optional acoustic signal).

Compact Construction

The especially developed aluminum extrusion frame permits the compact set-up of the MS600, the bowl feeder and the hopper unit on adjustable supports. At the same time the system can be modified to suit special needs: for example by using larger collector containers under the machine. All the control functions are integrated into one housing (Control Standard Variant II). This configuration is suitable for completely automated operation with a large degree of autonomy for large batches or large parts.

The MS600/6 is precise to within 6 μm , the MS600/2 enhances this to within 2 μm .

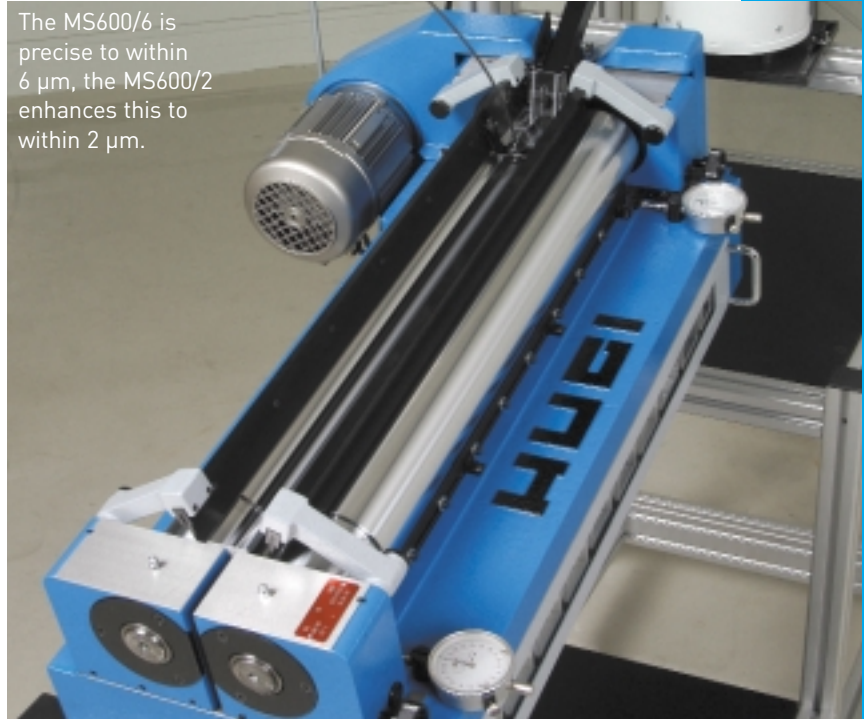

Easy to operate: draws and outlets are available in a number of variants.



Shown in the picture

- Control unit, Standard Variant II
- Presence control
- Dial gauges type M2T/15
- Standard drawer with 10 plexiglass collectors size 1
- Standard feeder HG150
- Hopper unit DE1 RS/Variant I
- Aluminum extrusion frame

Advice and Support

The standard Hugi MS600 is available as the table-top model MS600/2 for measurement accuracies to within 2 µm or the MS600/6 for an accuracy to within 6 µm:

- Control Standard Variant I
- Dial gauges KM4/5T
- Standard drawer with 10 plexiglass collectors size 1
- Standard feeder HG150
- Universal feeder controller unit WF
- Mounting plates for WF150
- Completely automated system for sorting small parts in any batch size



Ryf AG: your specialist for measurement and control systems

For over 40 years, Ryf AG has been the leading specialist in the field of microscopes, industrial optics, measurement technology and vision systems. Experienced experts ensure knowledgeable advice and, in dialogue with customers, provide complete concepts designed to meet individual requirements, and support their implementation until the system is ready to operate. All the solution variants can be examined and tested in the large showroom in Grenchen / Switzerland on appointment (by car: from Zurich about 60 min. from Berne about 30 min. drive).

Hugi MS600 – the mechanical complement

The proven and still unsurpassed Hugi MS600 is an individually adjustable measuring/gaging and sorting machine which ideally supplements the Ryf product range in the field of measurement and control systems. Its reliability and optimum cost-benefit ratio are its outstanding features. The system can be used in a wide variety of applications.

Let our team of technicians advise you!

