

OLYMPUS®

ryf ag
ryf
Ryf AG
Bettlachstrasse 2
2540 Grenchen
tel 032 654 21 00
fax 032 654 21 09
www.ryfag.ch

Optional Modules

SZ-ADD
SZ-POL-2
SZH-CLJ

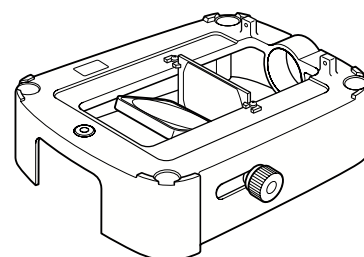

INSTRUCTIONS

SZ2-ILA

TRANSMITTED ILLUMINATION ATTACHMENT

This instruction manual is for the Olympus SZ2-ILA Transmitted Illumination Attachment. To ensure the safety, obtain optimum performance and to familiarize yourself fully with the use of this equipment, we recommend that you study this manual thoroughly before operating the system. Retain this instruction manual in an easily accessible place near the work desk for future reference.

— This publication is printed on 100% recycled paper —



A X 6 6 1 5