

## **Ryf R-FHD-1080 Mini Full HD camera system**



**Full-HD mini video camera system as a «replacement»  
for a stereo microscope**

**Comes complete! Unpack and plug & play - it can be that easy!**

- **HDMI connection**
- **up to 60 frames /sec.**
- **compact design**
- **crosshair fade in or out**
- **with 10" mini full HD screen 16x9**

## **Ryf R-FHD-1080 Mini Full HD camera system**



The professional compact High Definition Full HD video camera system Ryf R-FHD: Developed by Ryf and widely used in the watch industry, micromechanics, medtech and microelectronics.

The CMOS based camera produces a true 16x9 FHD image with up to 60 fps (frames/sec).

The very fast and compact camera can be connected to almost any monitor, TV or projector with HDMI port (no computer needed). A small F-HD 10" Display is included. The remote control is only needed to save the selected settings, then it may be stored away.

For more technical information, please see the separate manuals of the camera and the remote control.

Illumination can be selected individually.

[www.ryfag.ch](http://www.ryfag.ch)

# Ryf R-FHD-1080 Mini Full HD camera system



Ryf Mini Camera System  
with Knee Joints and Full  
HD 10" Mini Screen 16:9

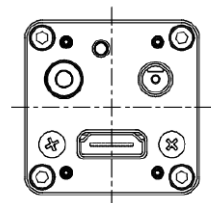
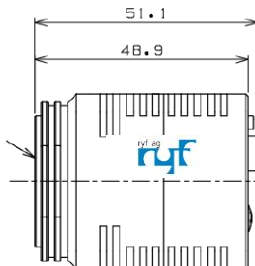
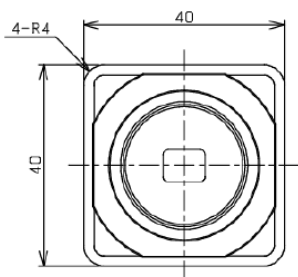
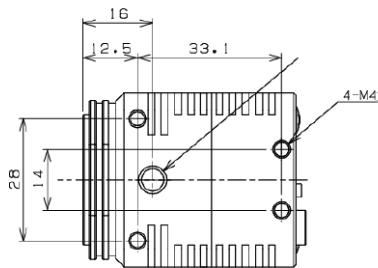

## **Ryf R-FHD-1080 Mini Full HD camera system**

- 50 - 60 frames/sec.
- 1920x1080 Pixel
- chip size 1/2.8", CMOS
- 16:9 format (no scaling)
- CMOS sensor (1920 x1080) with progressive scan
- Very good sensitivity and true color reproduction
- HDMI output connection: DVI (digital visual interface)
- Compact size (40mm x 40mm x 52mm)
- Light sensitivity (at 50% video signal) 5 lux at F1.2
- Lens / microscope C-mount
- Programmable by us on request: 28 storable profiles (system configuration, image, brightness, color)
- Pixel size 2.8 x 2.2 µm
- Input voltage 12 VDC
- Accessories: plug-in power supply and wired remote control on request

### **EN standards complied with:**

**EN55011:2008 + A2:2010 Group 1 class A**  
**EN61000-6-2005**  
**EN61000-4-2:2009**  
**EN61000-4-3:2006+A1:2008+A2:2010**  
**EN61000-4-4:2012**  
**EN61000-4-6:2014**  
**EN61000-4-8:2010**



### **Example:**

Mini camera system with adapter to standard microscope stand C-PS from Nikon or others.

**RYF AG**  
Bettlachstrasse 2  
CH-2540 Grenchen  
Tel. +41 32 654 21 00  
ryfag@ryfag.ch  
www.@ryfag.ch

**RYF SA Succursale**  
Route de Genève 9c  
CH-1291 Commugny  
Tel. +41 22 776 82 28  
ryfag@ryfag.ch  
www.@ryfag.ch

**RYF AG**  
Im Hanselmaa 10  
CH-8132 Egg / Uster/ ZH  
Tel. +41 43 277 59 99  
ryfag@ryfag.ch  
www.@ryfag.ch